

## GROUP 51

# EXTERIOR

## GENERAL

### OUTLINE OF CHANGES

- Service procedures have been changed due to the modification in the front bumper.
- Service procedures have been changed as “Mitsubishi” mark is changed into Three Diamond mark.
- GHI mark is added to correspond to the addition of the GDI engine models.

## FRONT BUMPER

### REMOVAL AND INSTALLATION

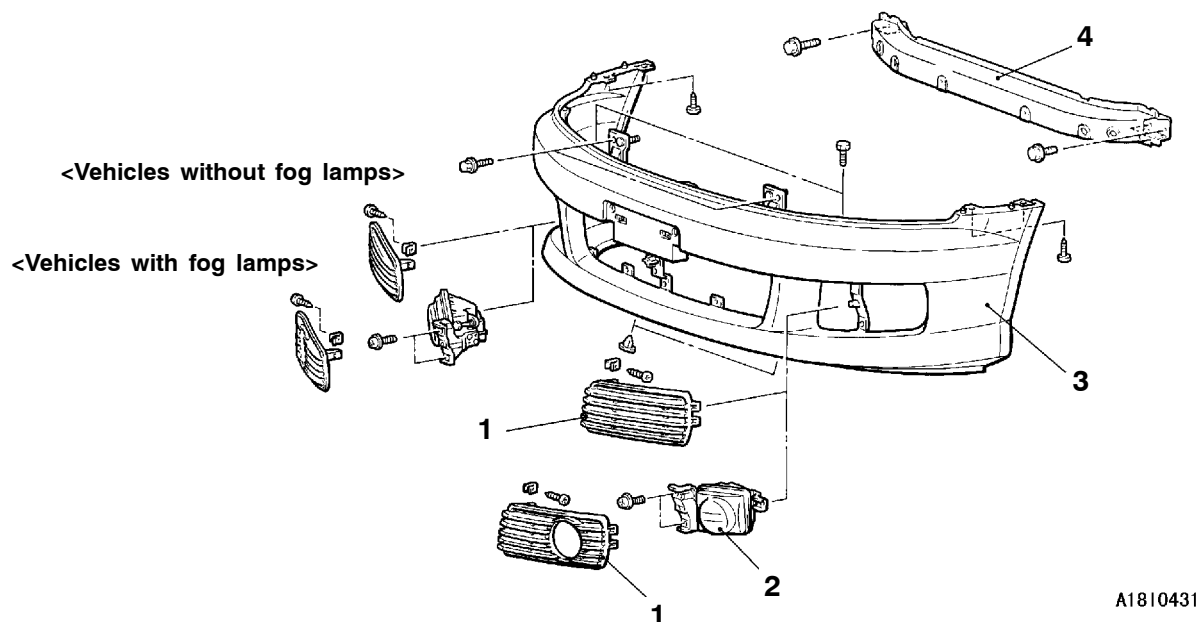

#### Removal Steps

1. Fog lamp bezel
2. Fog lamp
3. Front bumper assembly
4. Front bumper reinforcement assembly

## DISASSEMBLY AND REASSEMBLY

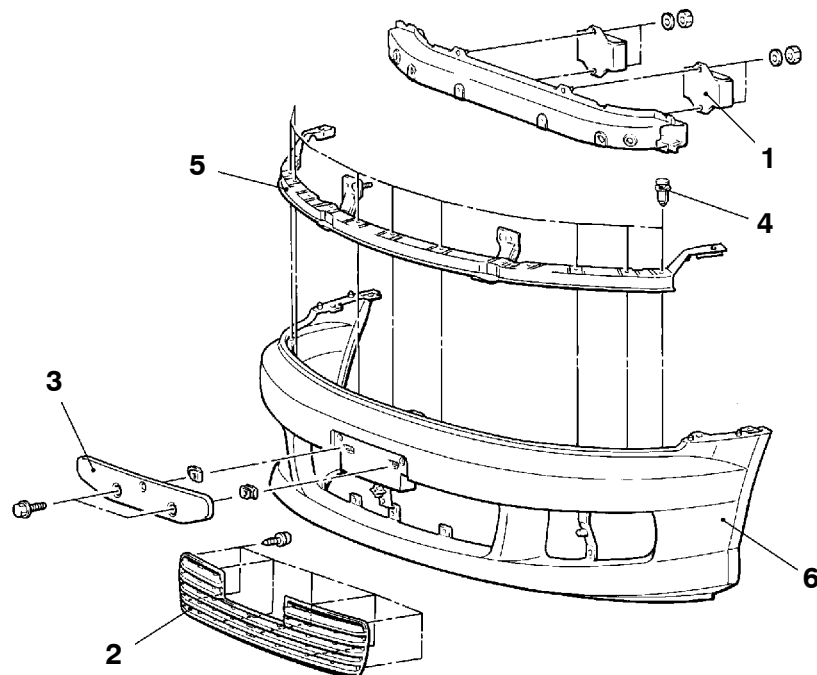

A1810486

**Disassembly Steps**

1. Dynamic damper assembly  
<Vehicles with 4G63 engine>
2. Under grille
3. Licence plate bracket

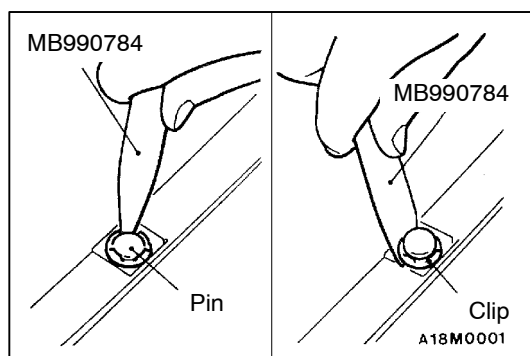

4. Clip
5. Front bumper upper reinforcement
6. Front bumper face

**DISASSEMBLY SERVICE POINT****◀A▶ CLIP REMOVAL**

1. Use the special tool to pull up the center pin in the clip.
2. Remove the clip.

## MARKS

## REMOVAL AND INSTALLATION

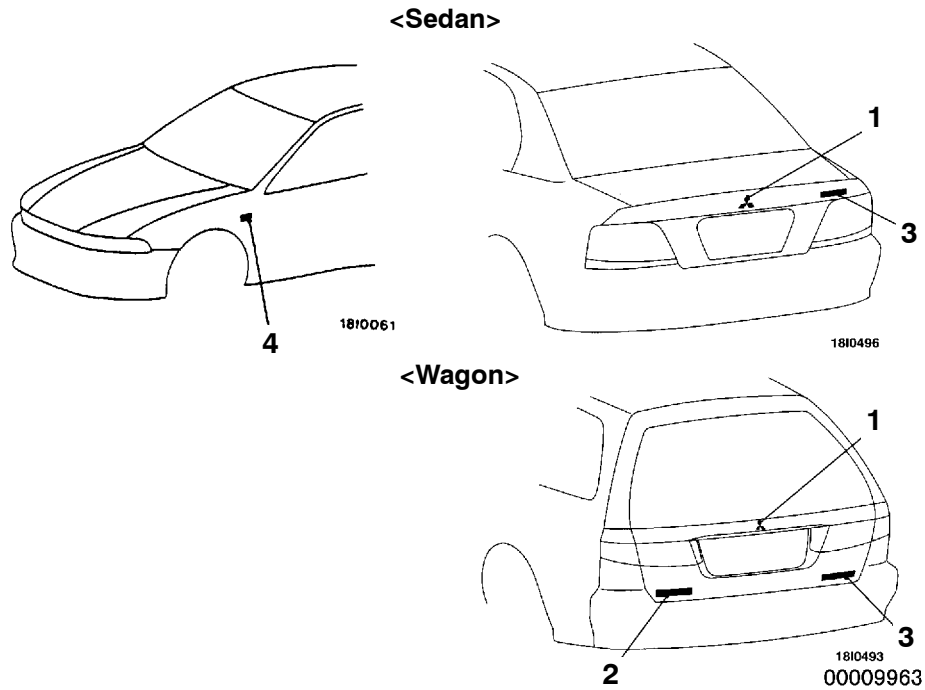

- ▶A◀ 1. Three Diamond mark  
 ▶A◀ 2. "GALANT" mark <Wagon>  
 ▶A◀ 3. Grade mark  
 ▶A◀ 4. GDI mark

## INSTALLATION SERVICE POINT

## ▶A◀ INSTALLATION OF MARKS

## 1. APPLICATION POSITION

(1) Three Diamond mark

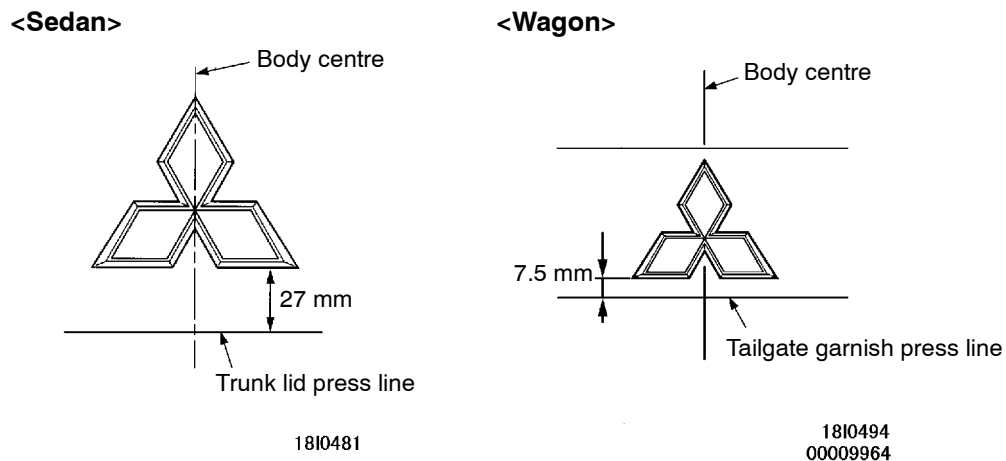

## (2) "GALANT" mark &lt;Wagon&gt;

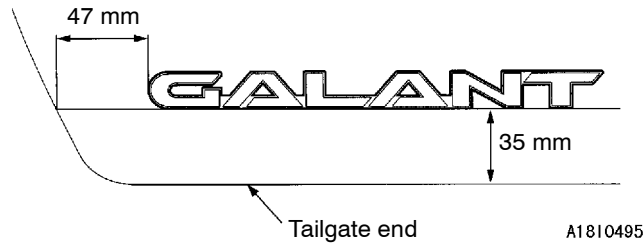

## (3) Grade mark

GLS (GDI)

&lt;Sedan&gt;

&lt;Wagon&gt;

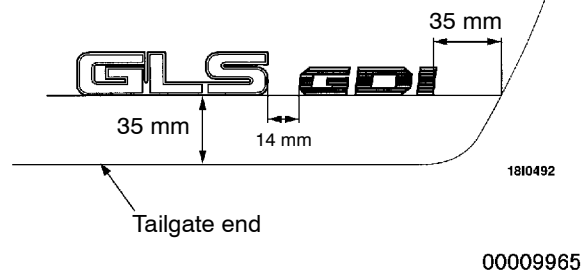
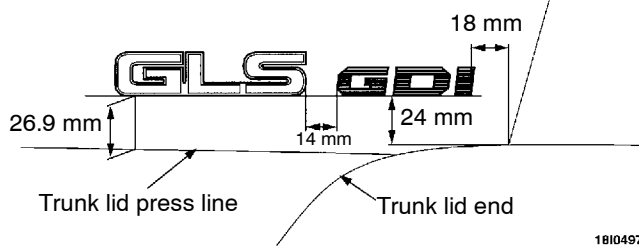

## (4) GDI mark

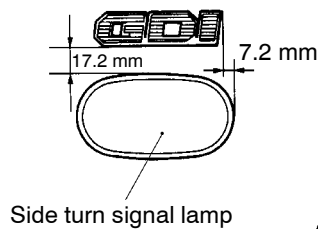

## 2. INSTALLATION PROCEDURE

- (1) Clean the mark installation surfaces on the body with unleaded petrol.
- (2) Peel off the backing paper from the reverse side of the marks, and then attach the marks to the vehicle body so that they fit properly into position.

**Caution**

When attaching the marks, the surrounding temperature should be 20–38°C and the air should be completely free from dust.

If the surrounding temperature is lower than 20°C, the marks and the places on the body where the marks are to be attached should be heated to 20–38°C.